

Category T (09)	Applicable Model/s 1995-97 Millenia	Subject FUEL/TRUNK OPENER SWITCH LOOSE	Bulletin No. 009/98
			Issued 08/05/98
			Revised

APPLICABLE MODEL(S)/VINS

1995 - 97 Millenia with VINs lower than JM1 TA22**W1405202.

DESCRIPTION

The fuel/trunk opener switch may become loose or detached from the door trim panel. This may be due to the speed nut interfering (contacting) with the switch causing the lock tab of the switch and/or speed nut being broken, loose or out of position. To correct this concern, the modified speed nut with a smaller diameter is available which prevents interference with the switch. Oil on the speed nut has also been removed to reduce cracking or breakage. Customers complaining of this concern should have their vehicle repaired according to the following procedure.

REPAIR PROCEDURE

1. Verify customer complaint.
2. Remove door trim panel using the following procedure.
 - A. Record preset stations on the vehicle's audio system.
 - B. Remove negative battery terminal.
 - C. Remove door mirror inner sail garnish. Pull out inner door handle cover.
 - D. Remove caps and three (3) installation screws "B".

Caution

- Do not remove the two (2) bottom screws "A" as shown.

- E. Insert fastener remover as shown and remove "C" fasteners.

Caution

- Protect the door with suitable padding to prevent damage.

Note

- Discard fasteners "C" after removal. Replace with new fasteners.

- F. Pull the sides and bottom of the door trim forward and disengage fasteners "A" from the door body.

Caution

- DO NOT pull the lower corners of the door trim panel. Damage to the trim panel may occur.

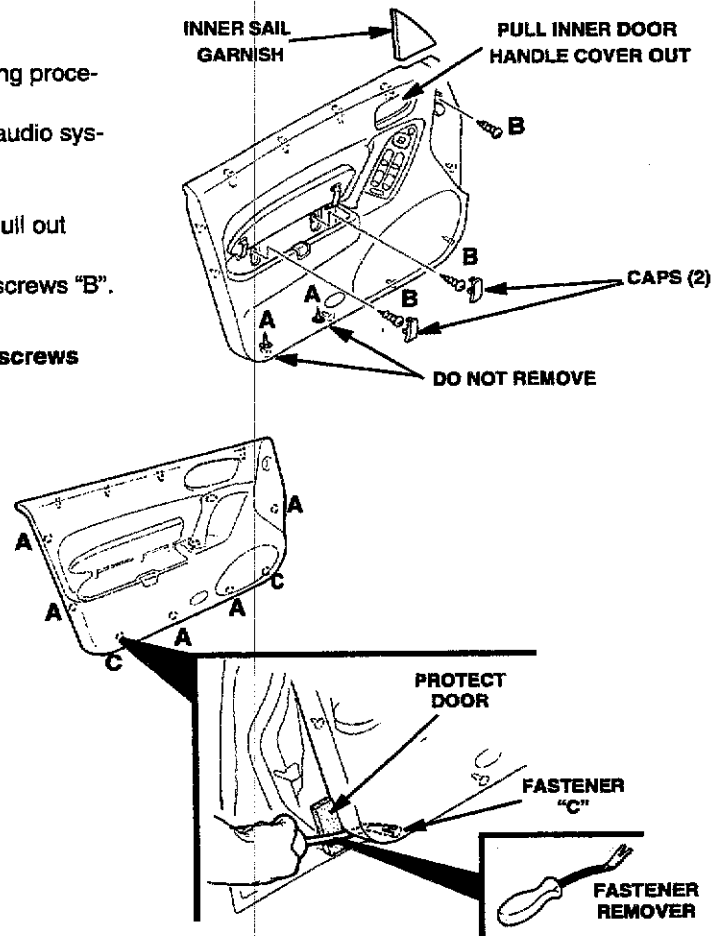

CONSUMER NOTICE: The information and instructions in this bulletin are intended for use by skilled technicians. Mazda technicians utilize the proper tools / equipment and take training to correctly and safely maintain Mazda vehicles. These instructions should not be performed by "do-it-yourselfers." Consumers should not assume this bulletin applies to their vehicle or that their vehicle will develop the described concern. To determine if the information applies, consumers should contact their nearest authorized Mazda dealership.

G. Lift the door trim panel UP then OUT together with "B" clips as shown.

H.

Caution

- If the door trim is not pulled UP before OUT, the "B" fasteners may break.

Note

- If "B" fasteners break, **DO NOT** replace the door trim panel. Replace only the door pull handle.

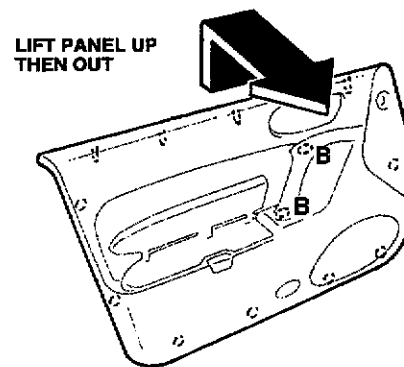

3. After door trim panel is removed, inspect the fuel/trunk switch lock tabs.

- If broken, replace the switch and use modified speed nuts.
- If not broken, replace the original speed nuts with modified ones.

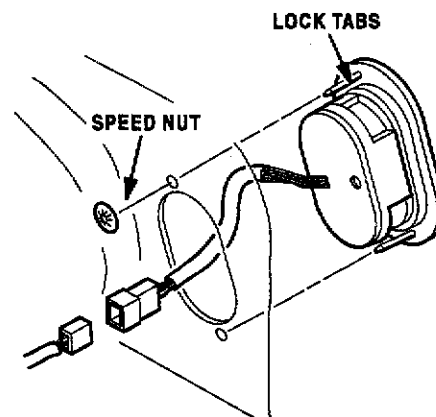
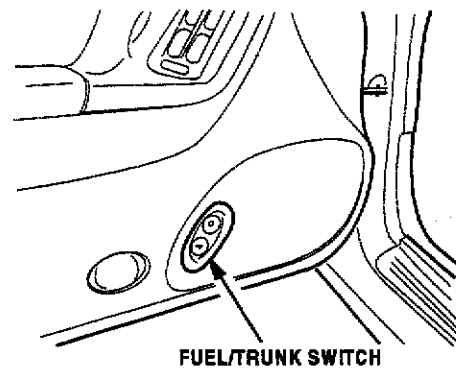

4. Install door trim panel using the following procedure.

A. Disconnect wiring harness.

B. Remove "B" clips from backside of panel using needle-nose pliers

Note

- If clips become difficult to remove, use a box knife or equivalent cutter to remove a small portion of the interfering material.

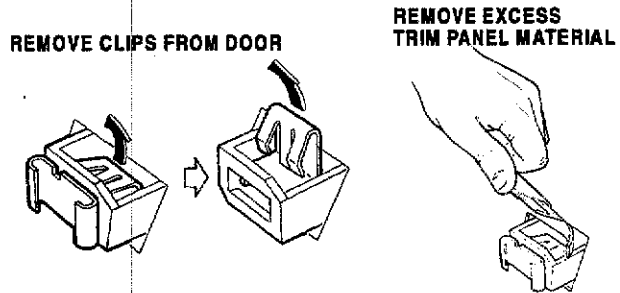
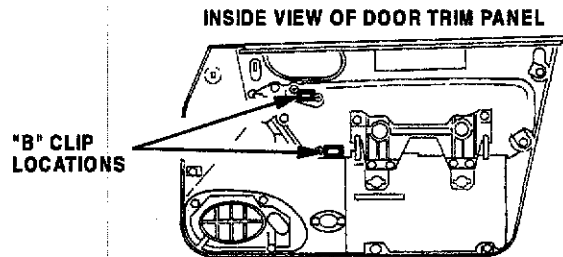

C. Install the clips to the grommets as shown.

Caution

- Make sure the upper clip finger/notch is pointing upward and the lower clip finger is pointed downward when reinstalling. Failure to reinstall the clips in the correct positions will make it impossible to remove the door trim panel again without damage.

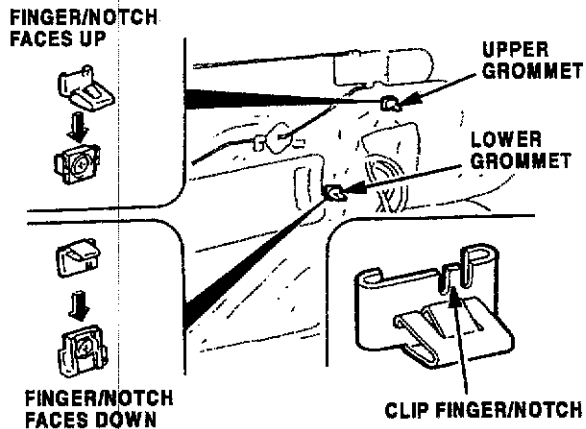

D. Connect wiring harness.

E. Hook the door trim weather-strip over the body and lower pin into the bracket point as shown.

Note

- Look through the door handle opening to verify the proper positions of the pin and bracket and the "B"clips with their holes in the door.

F. Apply pressure to the door panel to seat the pin and clips into installed positions.

G. Connect negative battery terminal to verify power window, locks and mirror operation.

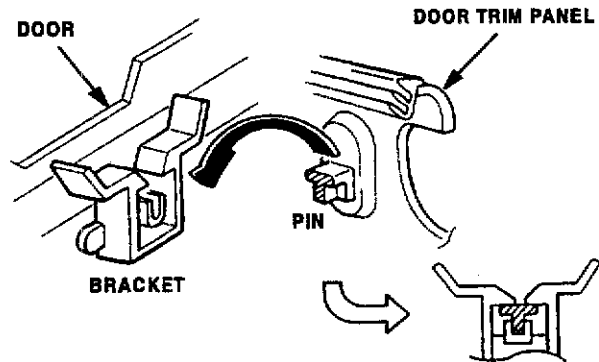

Number: 009/98	Date Issued: 08/05/98	Revised:
----------------	-----------------------	----------

H. Install:

- Screws
- Caps
- Inner door handle cover
- Inner sail garnish

I. Reset the preset stations of the vehicle's audio system preset stations (see STEP 2A).

5. Verify repair.

PART(S) INFORMATION

Part Number	Description	Qty.	Note(s)
TA01-66-630A-02	Fuel/Trunk Lid Opener Switch	0 or 1	Color - Black
TA01-66-630A-80	Fuel/Trunk Lid Opener Switch	0 or 1	Color - Beige
9YB32-0301	Speed Nut	2	---

WARRANTY INFORMATION

Note

- This information applies to verified customer complaints on vehicles covered under normal warranty. Refer to the SRT microfiche for warranty term information.

Warranty Type	A
Symptom Code	89
Damage Code	9A
Part Number Main Cause / Quantity	TA01-66-630A-02 or TA01-66-630A-80 / 0 or 1
Related Part Number / Quantity	9YB32-0301 / 2
Operation Number / Labor Hours	XX984XRX / 0.3